

PROJECT SPOTLIGHT | TRANSFER STATION FACILITY SITING - NORTH DALLAS REGIONAL SOLID WASTE PLANNING COMMISSION - DALLAS COUNTY, IOWA

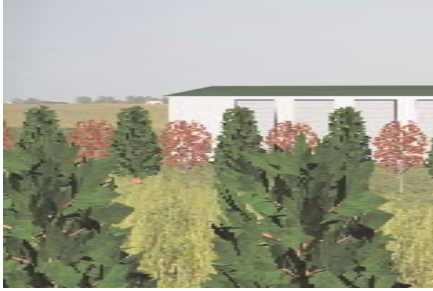

SCOPE OF PROJECT

The North Dallas Sanitary Landfill retained **BARKER LEMAR** to research and identify an appropriate location for a transfer station to service the North Dallas Regional Solid Waste Planning Commission's planning area. **BARKER LEMAR** would identify a general location, develop the facility's operational plans, and design the transfer station facility. Once the property was identified by the landfill, **BARKER LEMAR** would provide assistance with siting the facility.

IMPLEMENTATION

BARKER LEMAR populated geographic information systems (GIS) computer models with Census Bureau population figures. This data was used to identify the current and projected center of the service area's population. Housing permit data, current land zoning, and infrastructure data was then collected to determine the area's potential for future development.

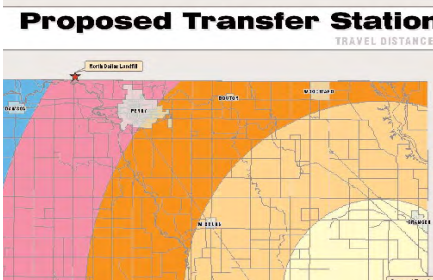

The landfill identified a property in this region for potential construction of the transfer station. **BARKER LEMAR** provided the commission with a transfer station facility design, 3-D modeling of the proposed facility, a comprehensive operational plan for the facility, developed a waste and wash water management plan for the facility, performed traffic studies to identify potential traffic improvements for facility traffic, and presented the information to the planning and zoning board, the board of supervisors, and to the board of adjustments. Ultimately the board of adjustments denied the zoning adjustment of the property from agricultural to the zoning category necessary for the construction and operation of the transfer station.

SERVICES

GIS; GPS; 3-D modeling; custom software programming/analysis; presentation of research.

TIMELINE

Project Start Date: January 2003
Project Completed: December 2004